

Impact sound insulation - under screed  
**REGUFOAM sound 10**  
under screed

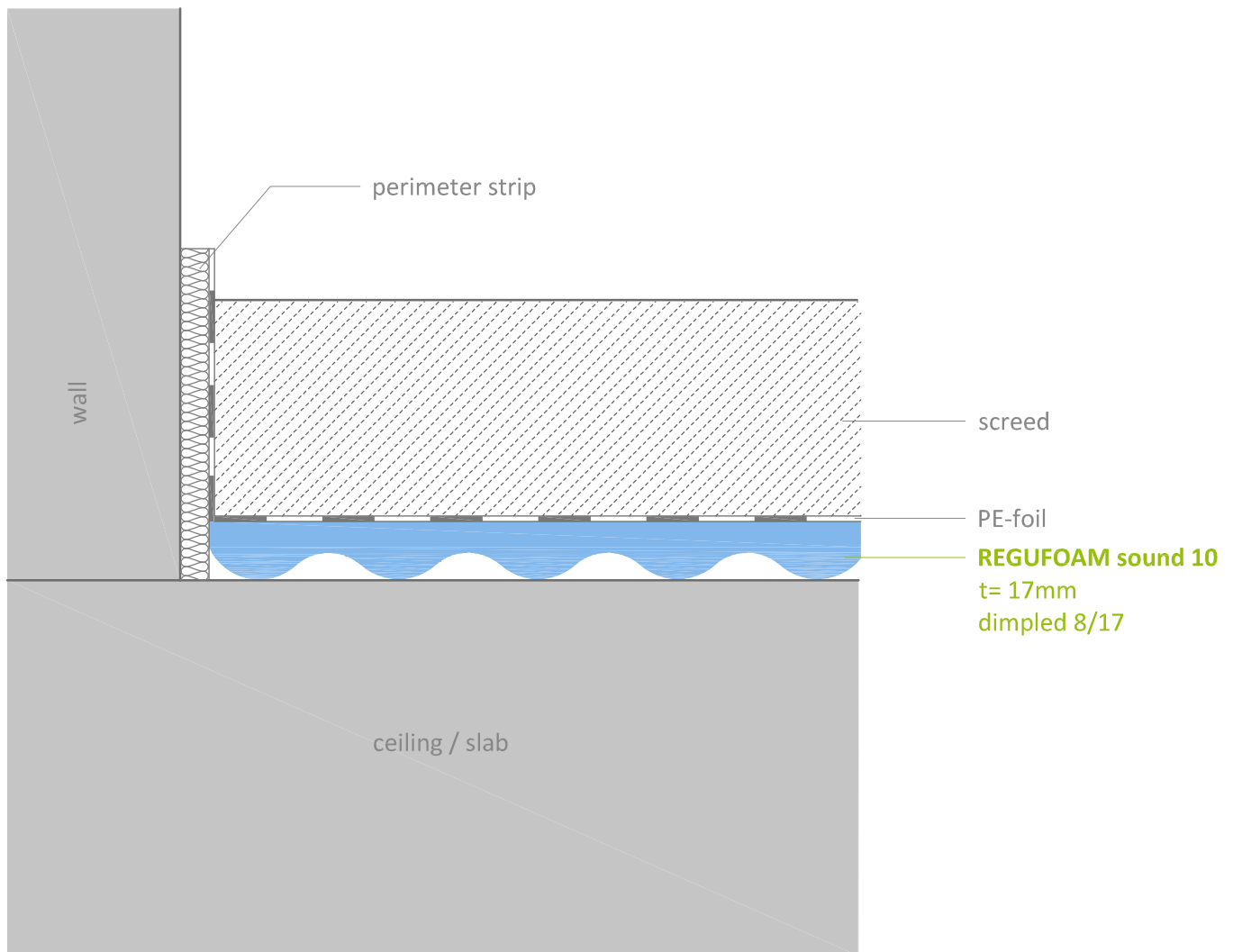

**Contact**

**REGUPOL Australia Pty. Ltd.**  
155 Smeaton Grange Road,  
Smeaton Grange NSW 2567  
AUSTRALIA  
[www.regupol.com.au](http://www.regupol.com.au)

**Notes**

Adjacent trades are only shown schematically and in parts. The applicability and other conditions or constraints need to be checked by the customer of user on their own responsibility. The technical data sheets, installation instructions and local conditions need to be considered.

**Project:** ---

Project-No.: ---

Detail: VSCHW-06-01-enAU

Version: 001

Date: 12.04.2021

Scale: 1 : 2